

# Organoid® Manual

Version 1.0: May 2025

## Recommendations for installing Organoid® Infinity Panels



Wall mounting  
Acoustic product

# Table of contents

STORING \_\_\_\_\_ 3

PLEASE NOTE \_\_\_\_\_ 3

WALL MOUNTING WITH INSULATION \_\_\_\_\_ 4

WALL MOUNTING WITHOUT INSULATION \_\_\_\_\_ 13

## Storing

Bring to room temperature before unpacking. Store product in closed, dry rooms, at a normal temperature and protected from light (at about 20°C and 30-60 % relative humidity).

## Please note

In case any anomalies and/or defects occur, Organoid® has to be contacted in written form immediately. Please check before installation if the delivery has any anomalies and/or defects.

Natural surfaces by Organoid® are made from natural plant fibres, therefore individual products of the same type may vary in colour, smell, or texture. Allow for the dimensions of the surfaces to vary up to +/- 2%, as they are unavoidable from a technical point of view. Small deviations due to these biological properties are therefore not a reason for complaint or warranty claims.

# Wall mounting with insulation

Infinity Panel width 192 mm with groove, with insulation, installation with screw claws

- **Fastening the substructure**
  - Screw the screws into the substructure batten, so that approx. 3-5 mm of the screw tip protrudes.
  - Align the batten exactly horizontally using a spirit level.
  - Press the slightly protruding screws against the wall to make precise marks for the dowel holes.
  - Drill holes and insert dowels
  - Select the dowels and screw length according to the condition of the wall.
  - Mount the battens at a distance of approx. 60 cm, matching the width of the insulation
  - When marking the positions of the battens on the wall, check the lateral position of the battens with a spirit level and ensure exact vertical alignment
  - Use the thickness of the battens of the substructure to match the thickness of the insulation, here 5 cm
- **Inserting the insulation:**
  - Insert the insulation boards into the spaces between the mouldings
- **Fasten the panels to the substructure battens**
  - Align the first panel and check with a spirit level to ensure an exact vertical position
  - Insert the screw claws into the groove of the panel and fasten to the substructure battens
  - The dimension of the screws is Ø 2.5 mm x length 25 mm
  - Insert the next panel into the previous screw claw and slide it on so that it is seamlessly flush with the previous panel. Then fit the screw claws again and repeat the previous steps.



Video tutorial: Organoid® Infinity Panel  
Wall mounting with insulation

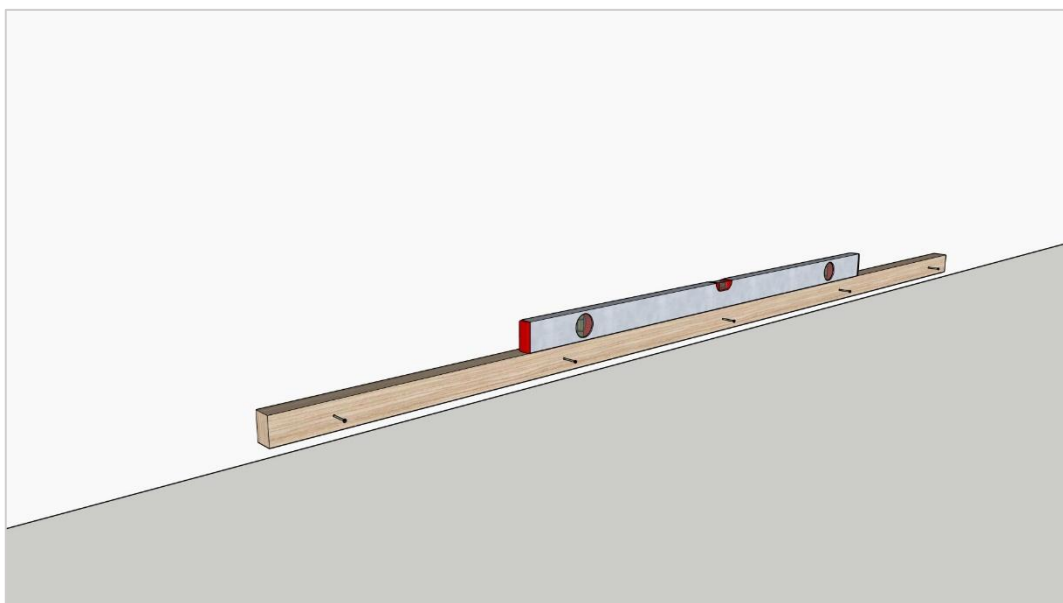
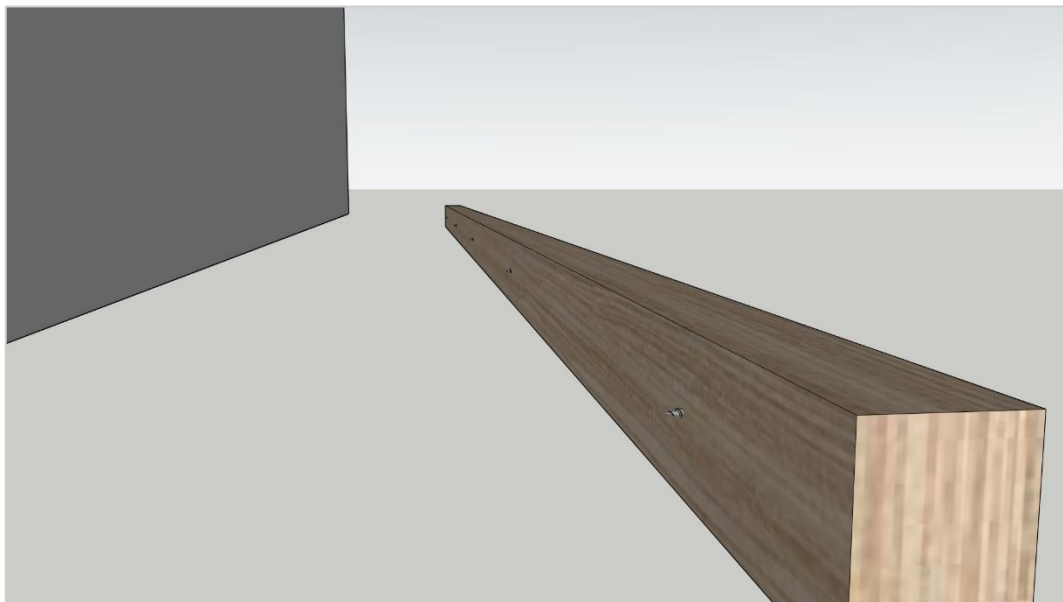
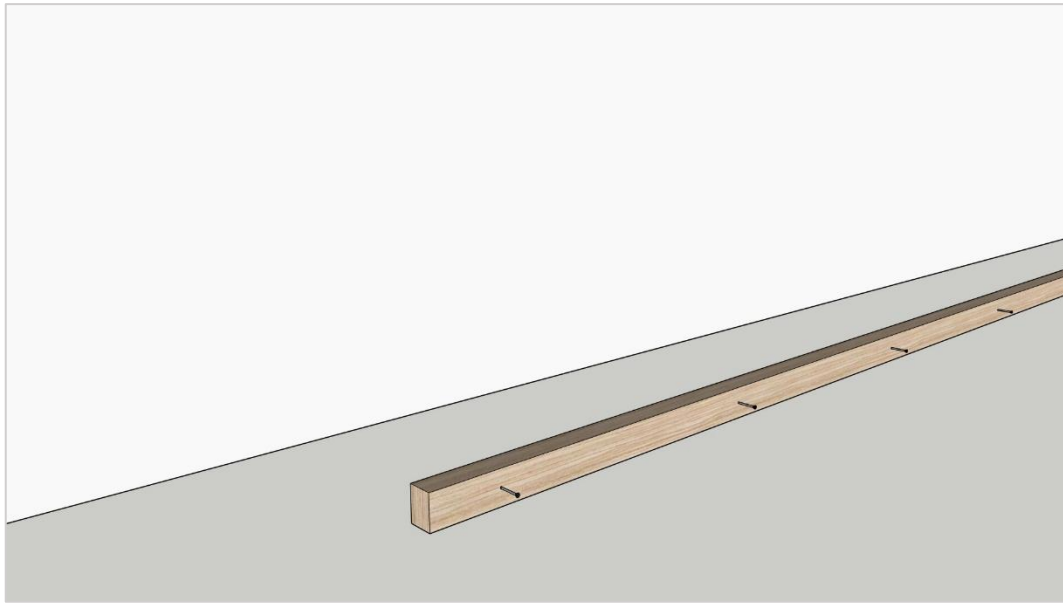

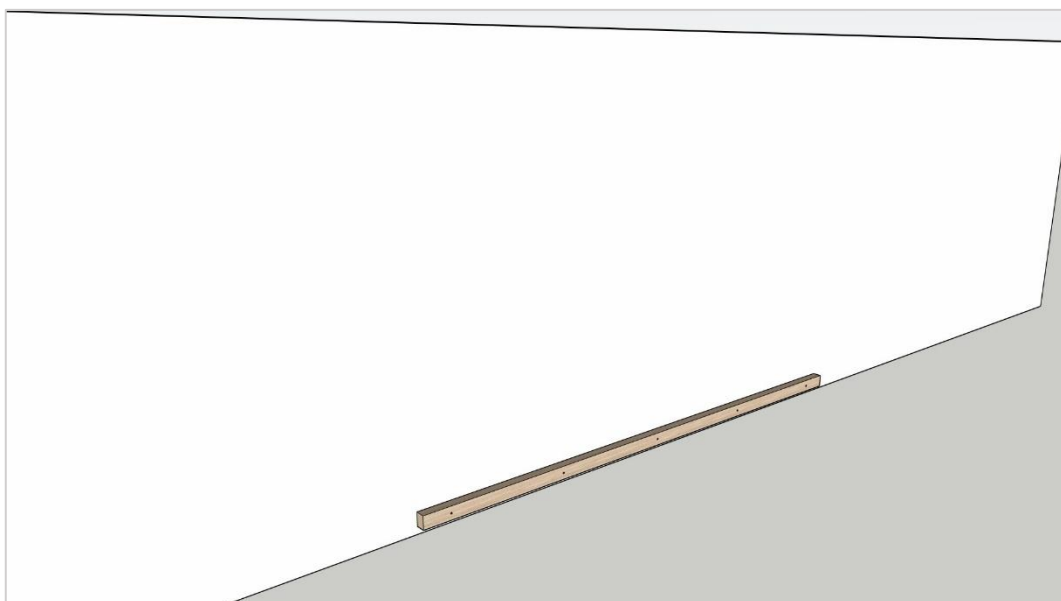
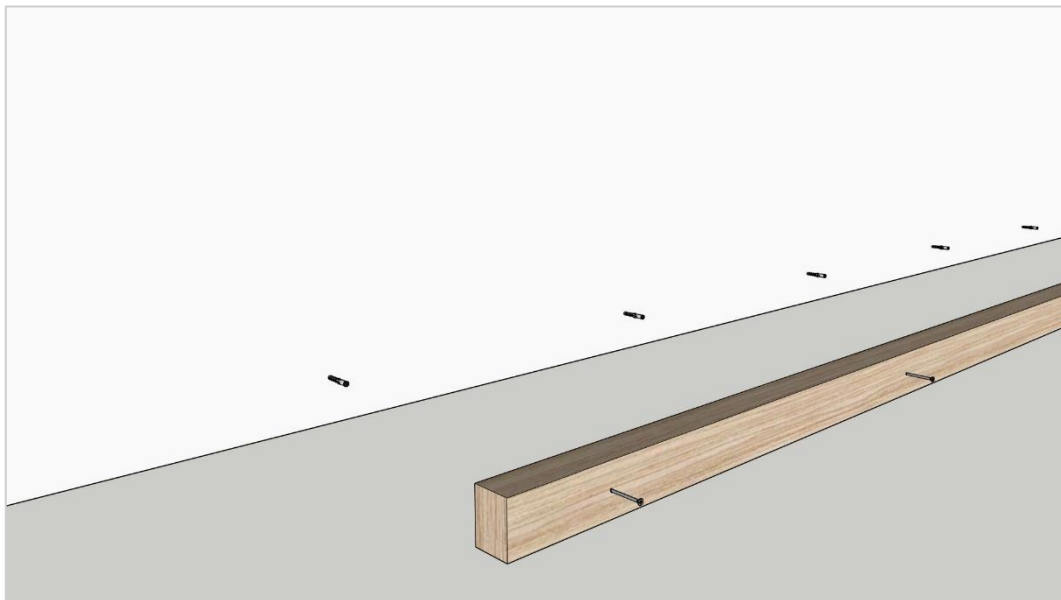
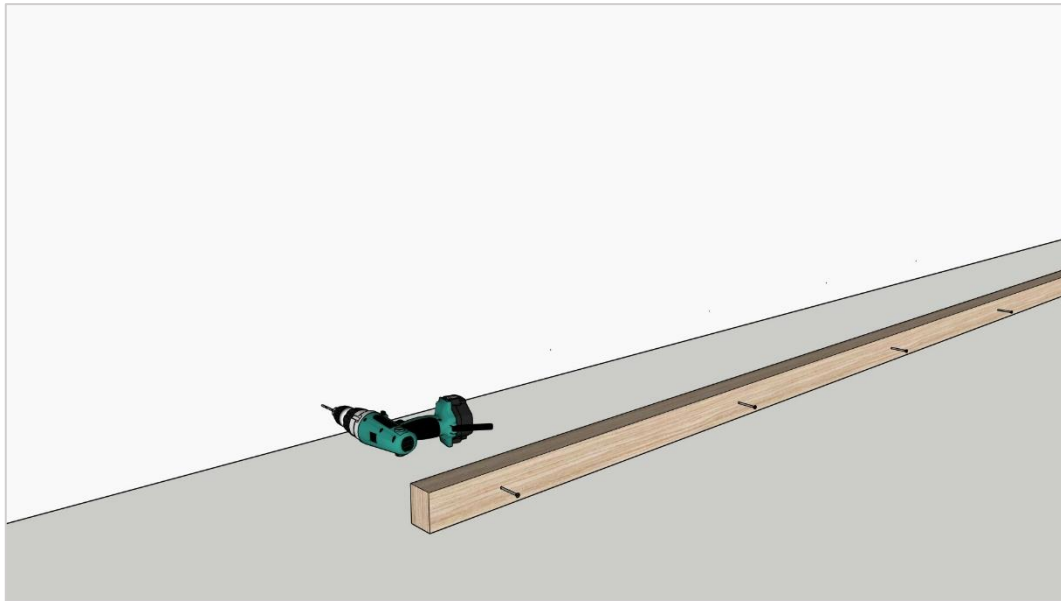

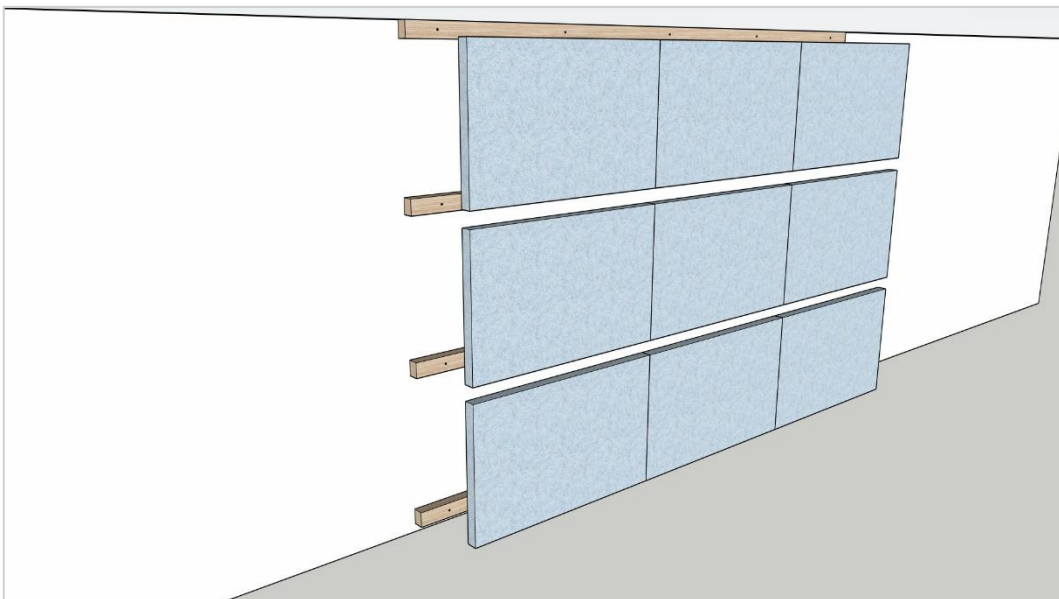
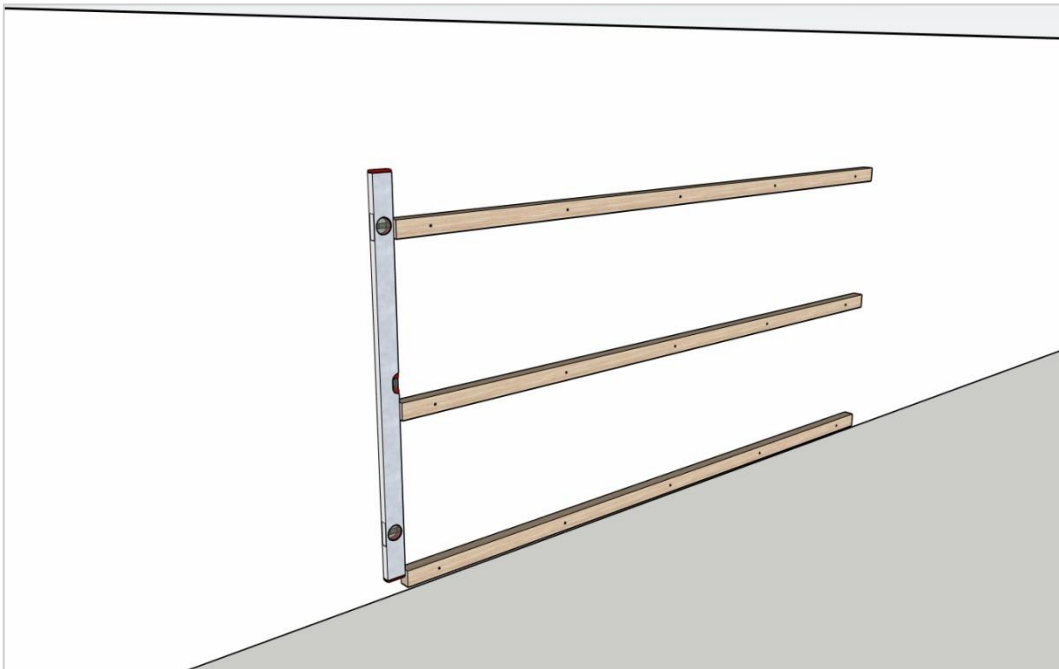
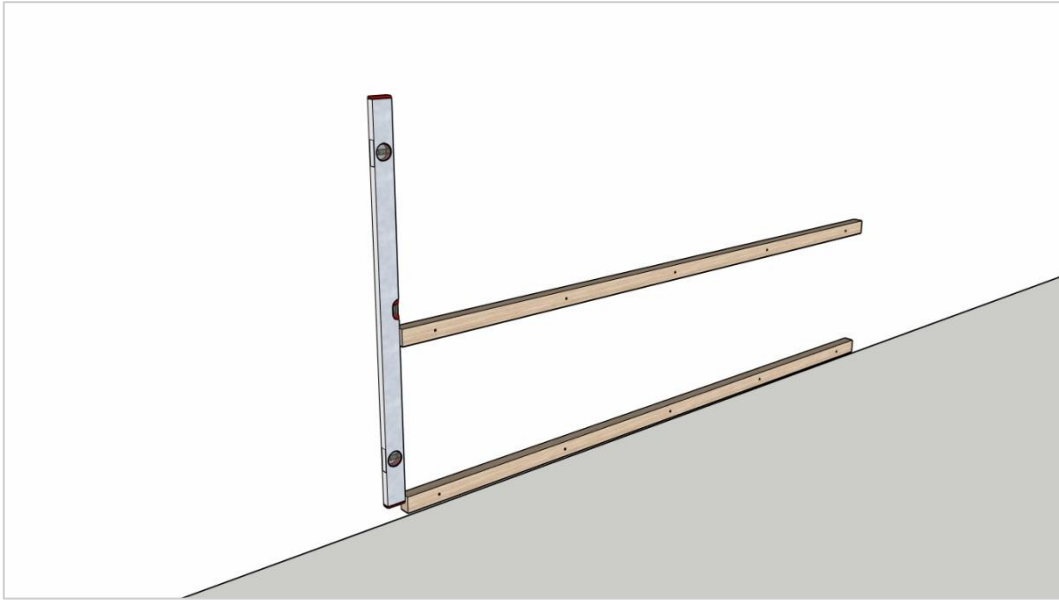

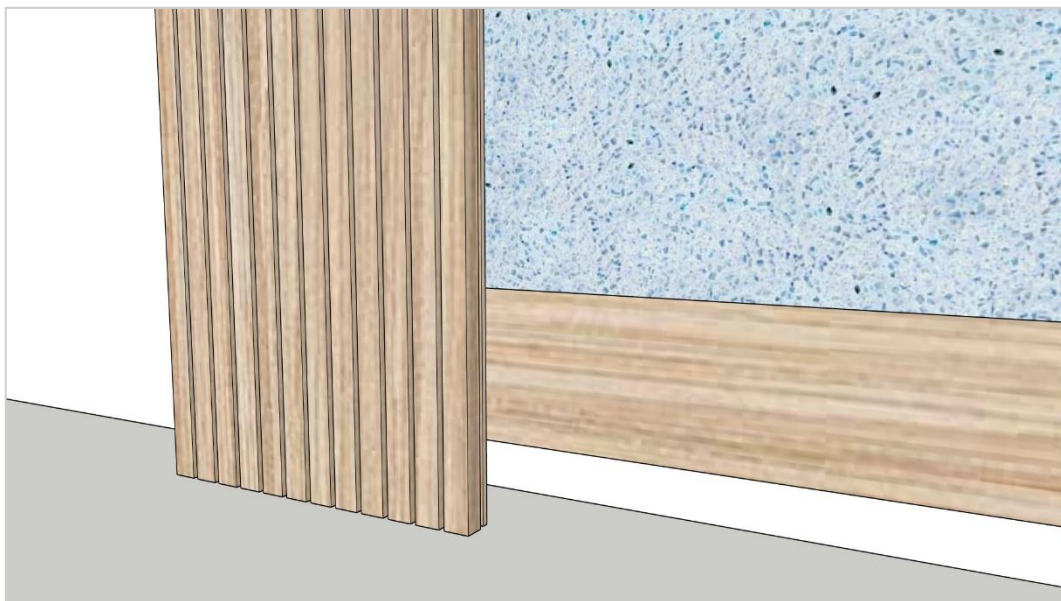
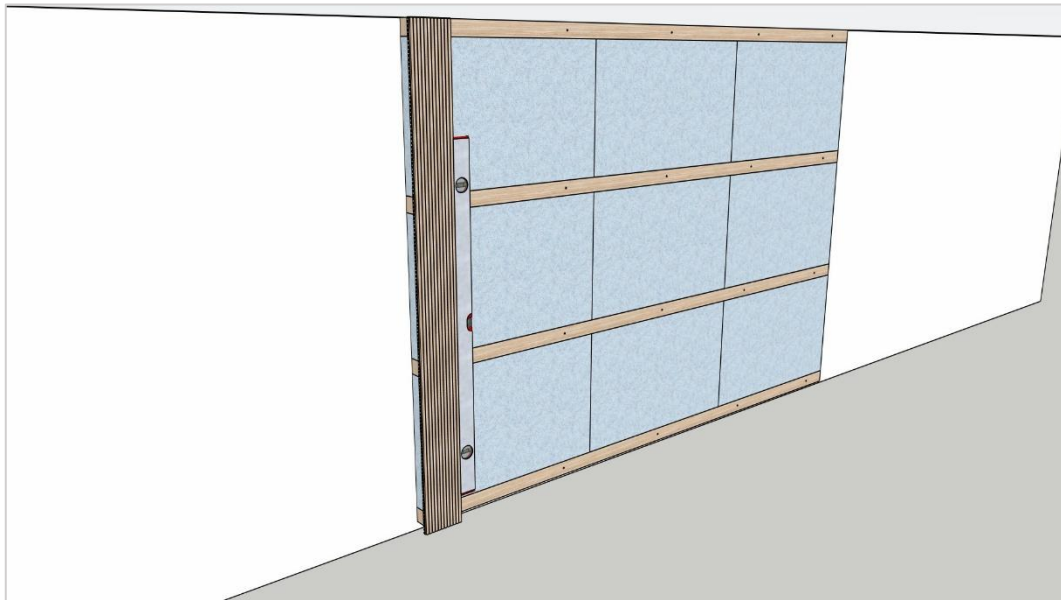
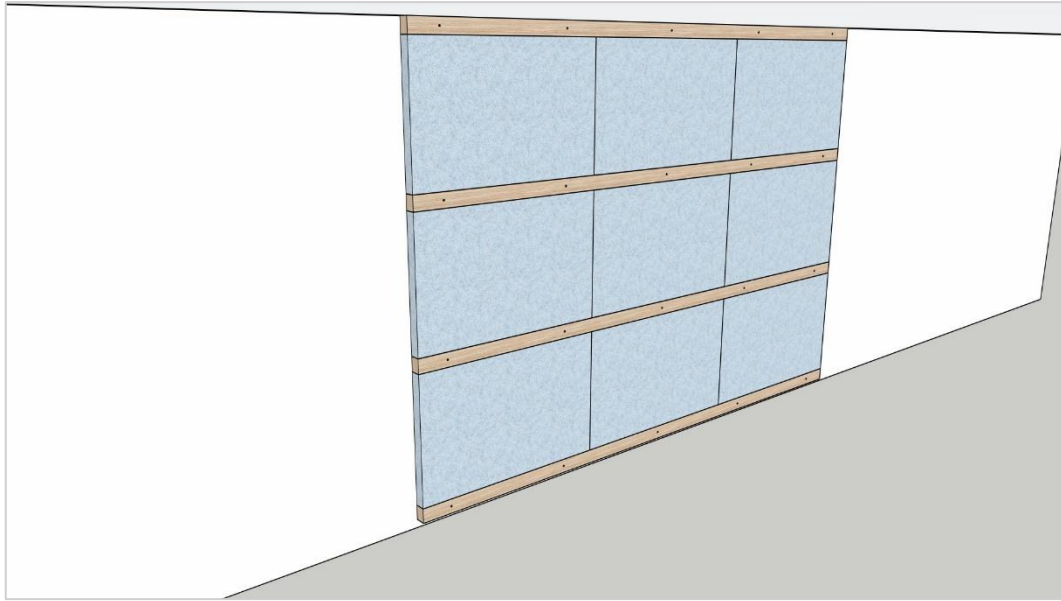





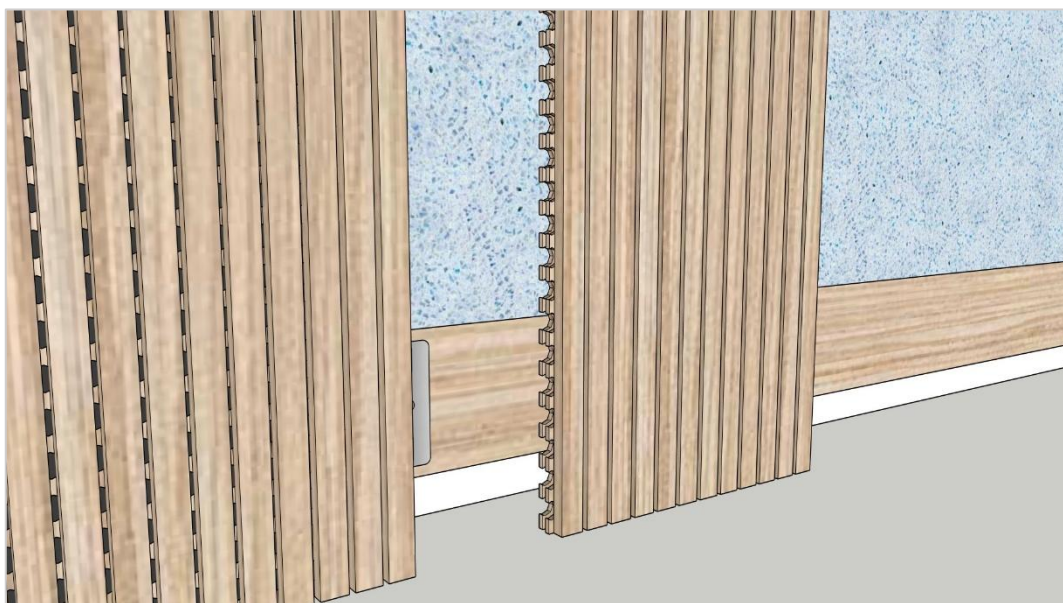



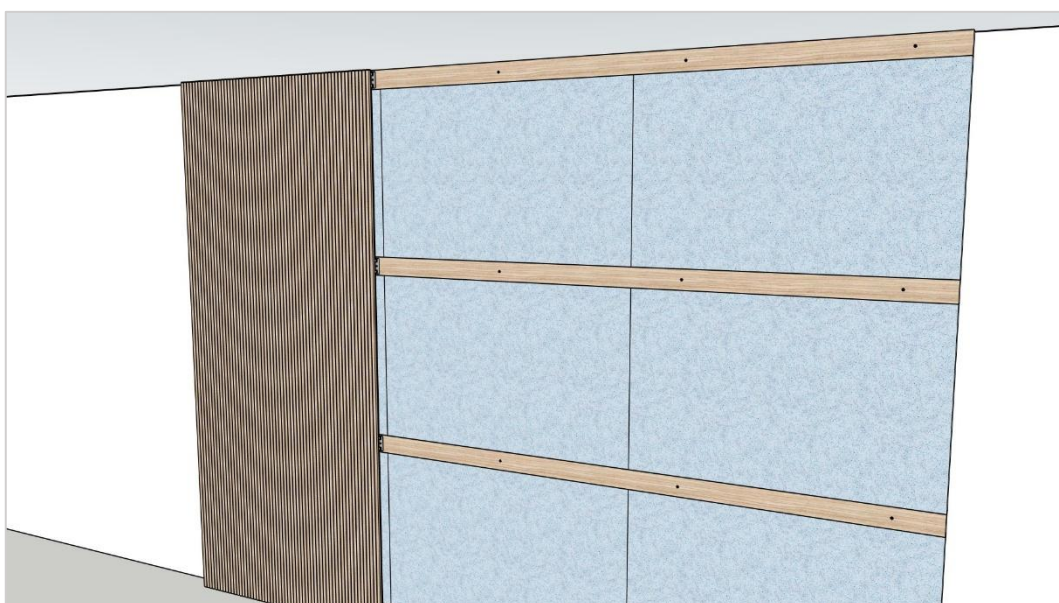
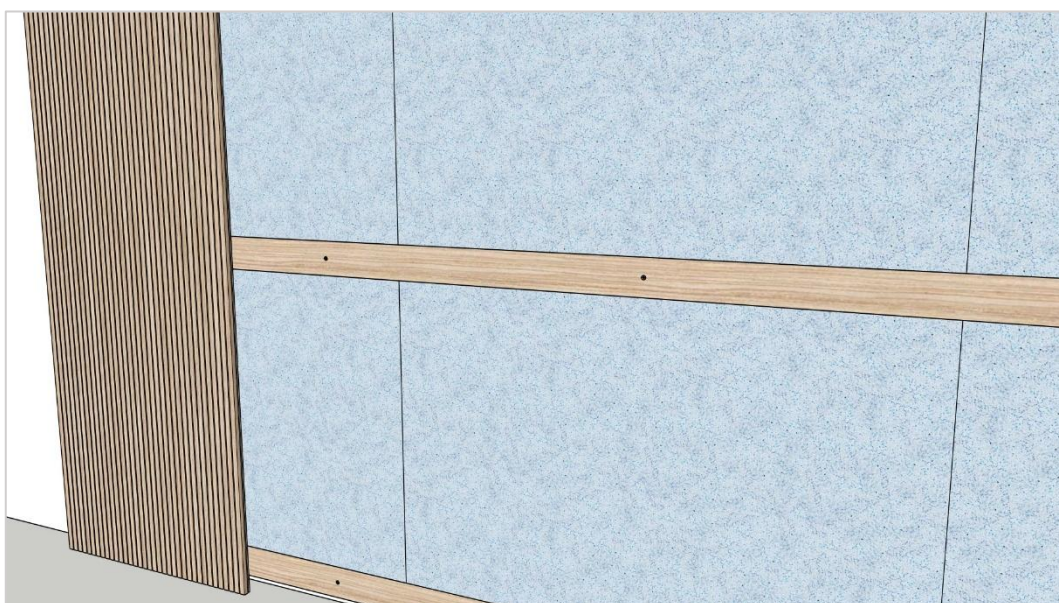
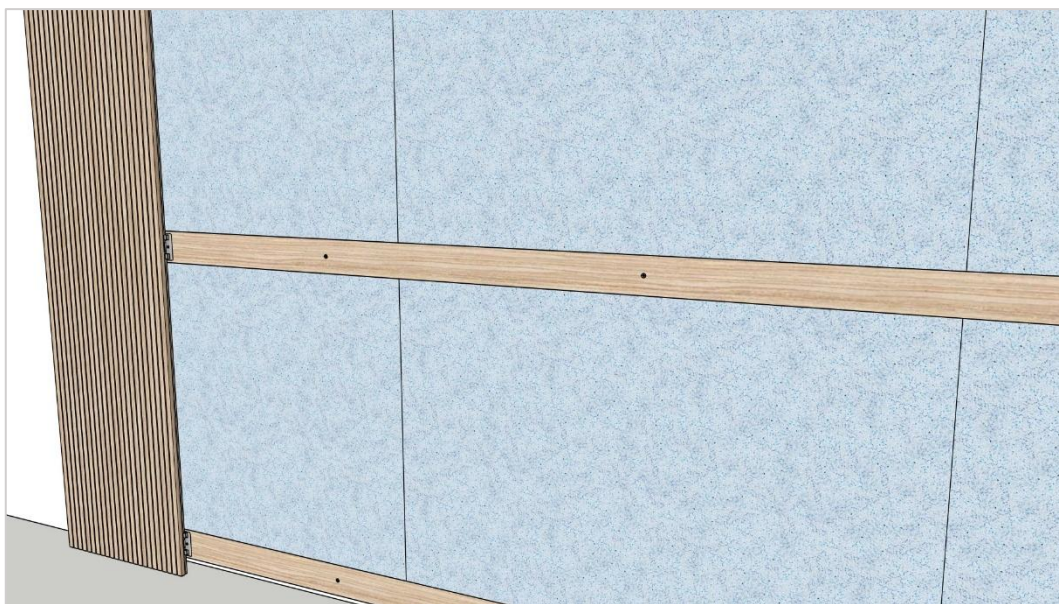



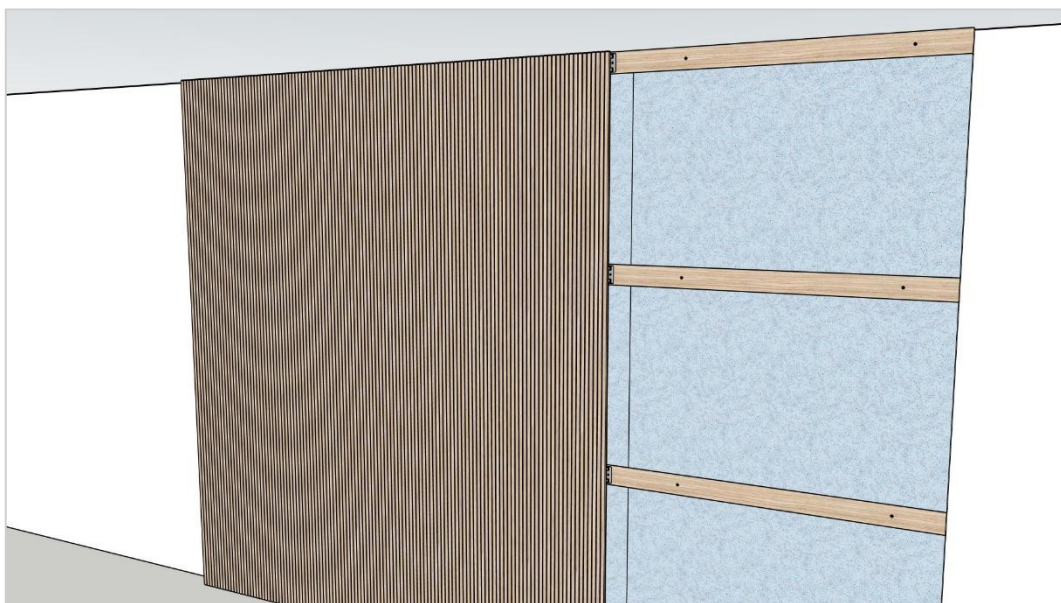
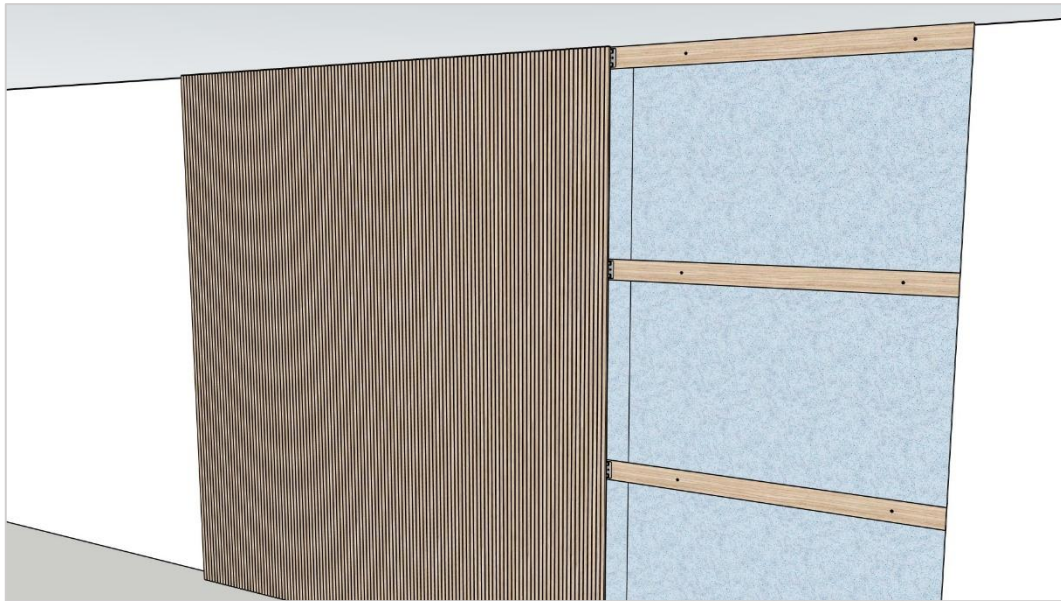

# Wall mounting without insulation

Infinity Panel width 192 mm with groove, without insulation, installation with screw claws

- **Fastening the substructure**
  - Screw the screws into the moulding of the substructure, so that approx. 3-5 mm of the screw tip protrudes.
  - Align the moulding exactly horizontally using a spirit level.
  - Press the slightly protruding screws against the wall to make precise marks for the dowel holes.
  - Drill holes and insert dowels
  - Select the dowels and screw length according to the wall condition.
  - Mount the mouldings at a distance of approx. 60 cm
  - When indicating the positions of the mouldings on the wall, check the lateral position of the mouldings with a spirit level and ensure exact vertical alignment
  - Thickness of the substructure mouldings approx. 2 cm
- **Fasten the panels to the substructure battens**
  - Align the first panel and check it with a spirit level to ensure an exact vertical position
  - Insert the screw claws into the groove of the panel and fasten them to the substructure battens
  - The dimension of the screws is Ø 2.5 mm x length 25 mm
  - Insert the next panel into the previous screw claw and push it on until it is seamlessly flush with the previous panel. Fit the screw claws again on the next panel and repeat the previous steps.



Video tutorial: Organoid® Infinity Panel  
Wall mounting without insulation

